

# Cleeve Road

KNOWLE

APPROXIMATE FLOOR AREA  
107.0 SQM / 1151 SQFT



## GROUND FLOOR

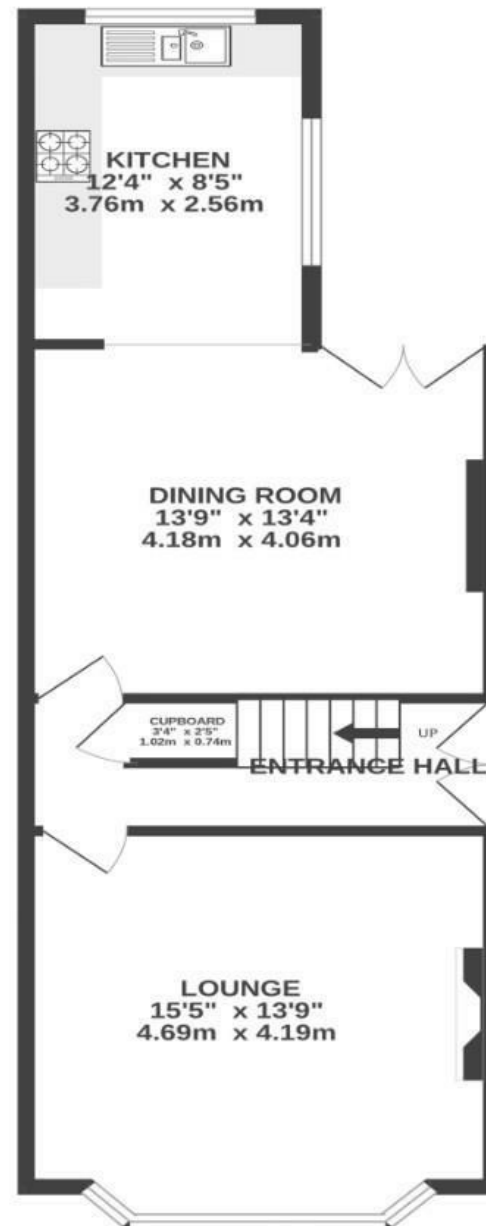

## FIRST FLOOR



Illustrations are for reference purposes only, measurements are approximate, not to scale.

**Boardwalk**

# Cleeve Road

KNOWLE, BRISTOL



£540,000



3 Bedrooms



BS4 2JP



1 Bathrooms

*"We've loved living on Cleeve Road it's a bright, welcoming home filled with natural light and good energy. The street is quiet and friendly, with neighbours who genuinely look out for one another, creating a lovely sense of community. We've really appreciated how easy it is to get into town—buses run regularly from nearby Wells Road. We've also enjoyed having beautiful green spaces within walking distance, not to mention great coffee shops and the Knowle Pub just around the corner."*

